

Electric Eel® CABLE & TOOL SELECTION GUIDE

MAINLINE TOOLS & ACCESSORIES

All tools & accessories listed below are compatible with Electric Eel Models C, D-5, R, RF, 325, 800 and work with 8' and 10' dual cables (all types) and 5/8" and 3/4" continuous cables.

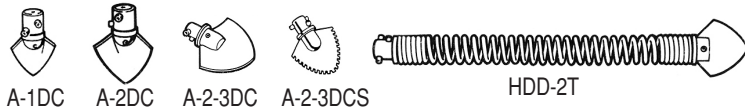

A-1DC

A-2DC

A-2-3DC

A-2-3DCS

HDD-2T

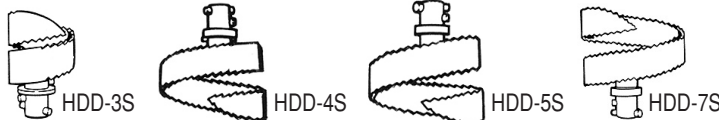

HDD-3S

HDD-4S

HDD-5S

HDD-7S



U-3

U-4

U-6

U-4H

UC3



HDD-U3

HDD-U4



EX-4A

EX-6A

EX-8A



HDD-3S-P

HDD-4S-P

HDD-4S-31/2-P

HDD-5S-P

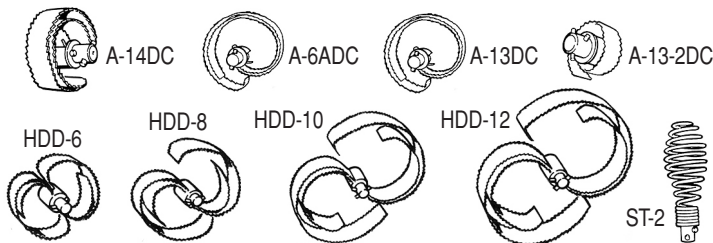

A-14DC

A-6ADC

A-13DC

A-13-2DC

HDD-6

HDD-8

HDD-10

HDD-12

ST-2

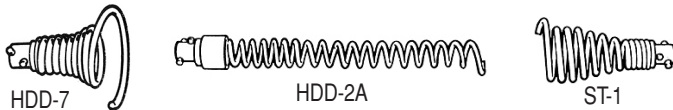

HDD-7

HDD-2A

ST-1

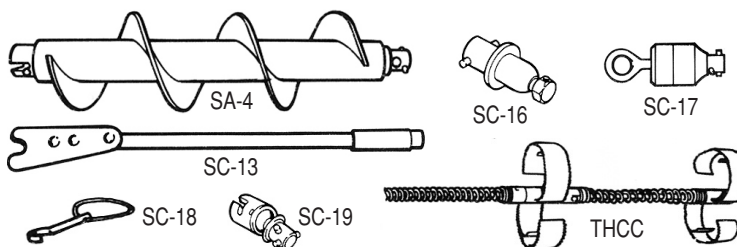

SA-4

SC-16

SC-17

SC-13

SC-18

SC-19

THCC

INITIAL OPENING TOOLS

- A-1DC 1 7/8" Diameter for 3" or larger pipeline
- A-2DC 2 3/8" Diameter for 4" or larger pipeline
- A-2-3DC 3" Diameter for 4" or larger pipeline
- A-2-3DCS 3" Ice chopping tool for 4" or larger pipelines
- HDD-2T 2 3/8" Spear point on 12" flexible spring for 4" or larger pipeline

HEAVY-DUTY ROOT SAW TOOLS

- HDD-3S For 3" pipeline
- HDD-4S For 4" pipeline
- HDD-5S For 6" pipeline
- HDD-7S For 8" pipeline

GREASE TOOLS

- U-3 For 3" pipeline (also available in Heavy duty)
- U-4 For 4" pipeline (also available in Heavy duty)
- U-6 For 6" pipeline (also available in Heavy duty)
- U-4H Heavier duty for 4" pipelines
- UC3 For 3" pipeline

FLEXIBLE SPRING TOOLS

- HDD-U3 12" Spring with U3 blade for 3" pipeline
- HDD-U4 12" Spring with U4 or HD blade for 4" pipeline

EXPANSION TOOLS

- EX-4A For 3" - 4" lines
- EX-6A For 4" - 6" Lines
- EX-8A For 6" - 8" lines

SLUDGE BUSTER TOOLS

- HDD-3S-P 2 3/8" Heavy duty sludge pusher for 3" pipelines
- HDD-4S-P 3" Heavy duty sludge pusher for 4" pipelines
- HDD-4S-31/2-P 3 1/2" Heavy duty sludge pusher for 4" lines
- HDD-5S-P 5" Heavy duty sludge pusher for 6" lines

FINISHING TOOLS

- A-14DC 3 1/2" Diameter tool for 4" or larger pipelines
- A-6ADC 5" Diameter for 6" or larger pipelines
- A-13DC For 4" conductor lines
- A-13-2DC For 3" conductor lines
- HDD-6 "S" Shaped for 6" lines
- HDD-8 "S" Shaped for 8" lines
- HDD-10 "S" Shaped for 10" lines
- HDD-12 "S" Shaped for 12" lines
- ST-2 Bulb shaped tool for 4" plastic pipeline

RETRIEVING TOOLS

- HDD-7 3" Tool for retrieving objects from pipeline
- HDD-2A Longer, thinner right hand wound retriever
- ST-1 Right hand wound retrieving tool

ACCESSORIES

- SA-4 Sand auger tool - Affix a spade-type tool for use on culverts under roadways
- SC-13 Feeding tool for use on "P" traps
- SC-16 Torque wrench adapter
- SC-17 Swivel cable puller for threading cable through pipeline
- SC-18 Spanner wrench for disconnecting cables/tools
- SC-19 Drop head adapter - provides swivel joint between cleaning tool and cable
- THCC Connector cable for connecting tools in tandem (tools not included)